

HORNETMV - SPARE PARTS AND ASSEMBLY

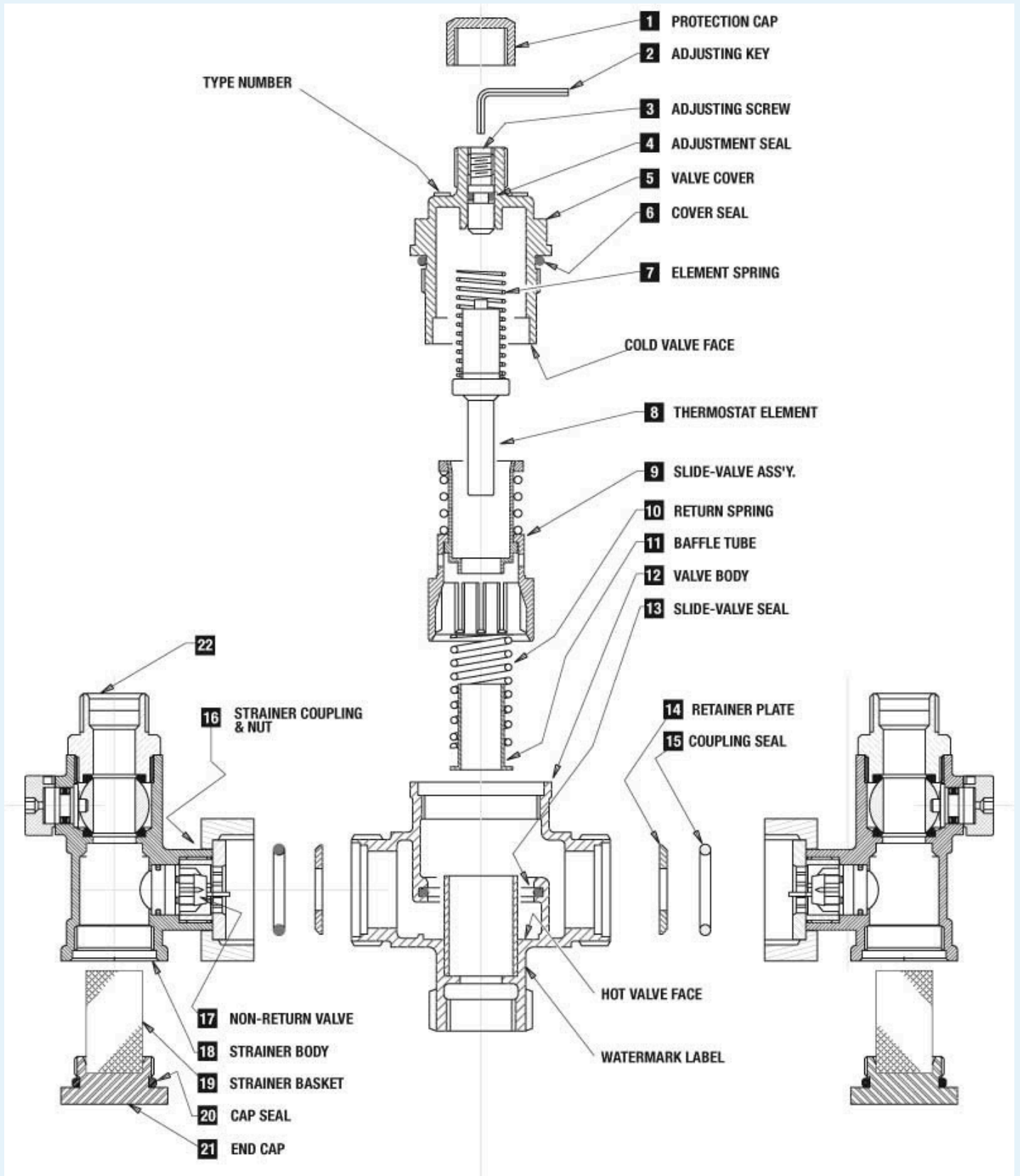



HORNETMV - SPARE PARTS AND ASSEMBLY

| Item | Part No. | Spare Part |
|------|----------|---|
| 4-6 | 91042 | Horne 1502 Service "O" ring kit |
| 8 | 91043 | Thermostat Element |
| 9 | 91076 | Slide Valve Assembly |
| 10 | 91206 | Return Spring |
| 11 | 91202 | Baffle tube |
| 13 | 91020 | Slide Valve Seal |
| 15 | 91042 | *Coupling Seal |
| 19 | 91073 | Strainer Basket - Old Style |
| 19 | 99109 | Strainer Basket - New Style |
| 20 | 91042 | *Cap Seal |
| 22 | 91160 | Inlet & Filter Assy - Large Handle - New or Short |
| 22 | 91212 | Inlet & Filter Assy - Small Handle - Old or Long |
| | 91042 | Seal Kit - complete |
| | 91075 | Flushing Kit - Old Style |
| | 91182 | Flushing Kit - New Style |
| | 91091 | Seal Removal Tool Kit |



HORNETMV - SPARE PARTS AND ASSEMBLY

| Item | Part No. | Spare Part |
|--------------|-----------------|---|
| | 91183 | Lapping Mandrel |
| | 91139 | Test plugs Horne |
| | 91156 | Horne TMV Bracket |
| | 99332 | 20mm Copper Pipe & Union + Test Plug |
| | 91087 | Horne 20 "O" ring service kit |
| | 91198 | Horne 20 H2002 Thermostat Element |
| | 91099 | Horne 20 H2003 Thermostat Element |
| | 91083 | Horne 20 Slide Valve Seal |
| | 91166 | Horne 25 Slide Valve "O" ring kit |
| | 90156 | T/Elements PKT of 15 |
| | 91164 | Slide valves PKT of 10 |
| | 91058 | Slide valve seals pkt of 10 |
| 4 - 6 | 88377 | 15 x 91042 |
| 2 | 88377 | Horne H1502 Adjusting Screw Kit |
| | 91093 | Horne 15 Retaining Disc Kit |
| | 43044 and 43026 | Flat Stainless Steel Cover, Hinged / Flat Stainless Steel Lid, no Hinge |